

# ZX-PA Series – Installation Guide

## Specifications

Potentiometer Value..... 5000  $\Omega$   $\pm$ 10%  
 Excitation Voltage (+Ve)..... 30 VDC Max.  
 Linearity.....  $\pm$ 1.0% Full Scale  
 Operating Temperature..... -55°C to 100°C

## Electrical Cable Wiring

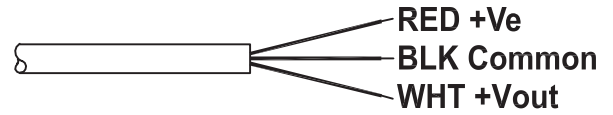

## Dimensional Information

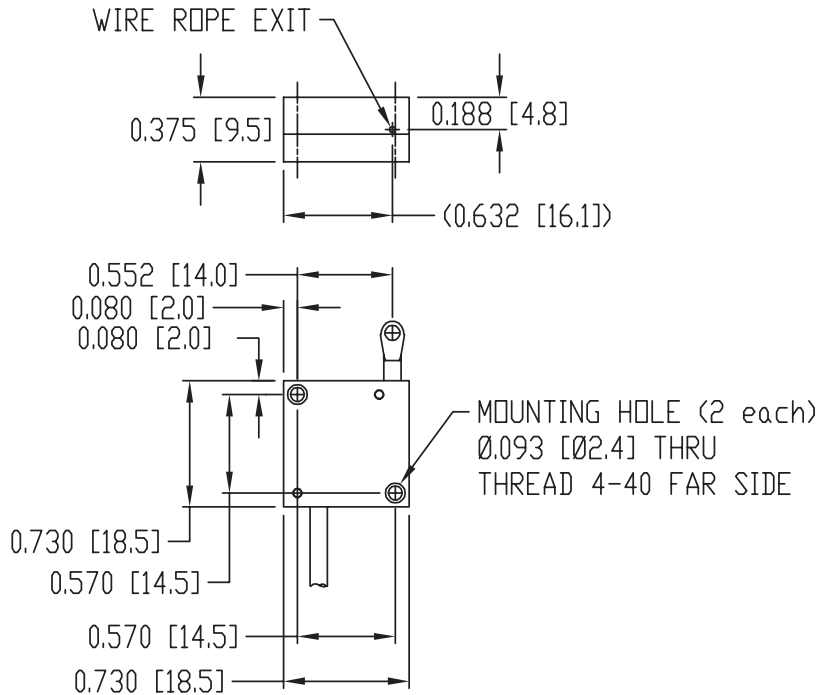

## OPTION A – Eye Fitting

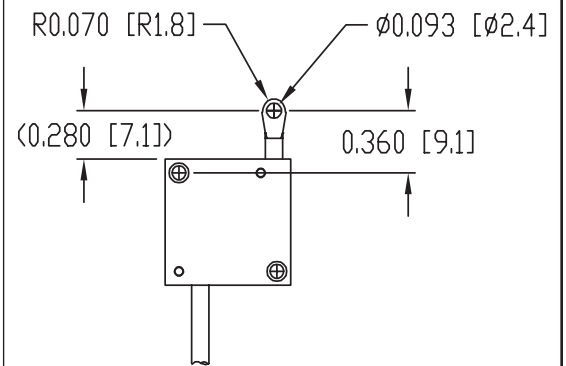

## OPTION B – Leader Wire Rope with Clip

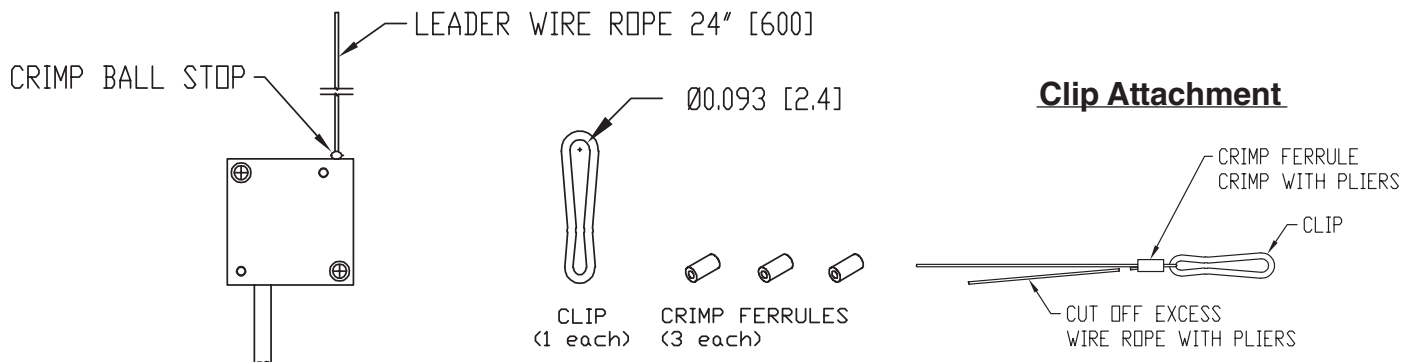

Dimensions in brackets are in millimeters

400261a.indd, 400261a.pdf