

GAIN AND OFFSET ADJUSTMENTS SEALED (CODE 'Y')

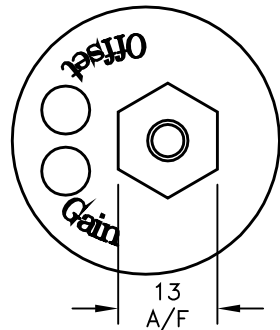

IP67 SHORT CABLE GLAND (CODE 'Mxx'/'MQxx')

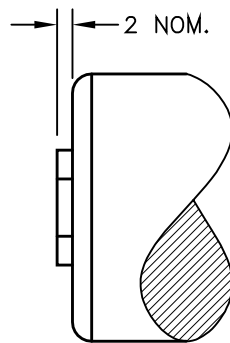

NOTE: SENSORS WITH TRAVEL UP TO 50mm ARE MADE IN STANDARD LENGTHS.

TRAVEL: (mm)	BODY LENGTH: (mm)
CALIBRATED MECHANICAL	'X' STANDARD 'Y' FLANGE
2 - 10	10 65.0 81.3
11 - 20	20 75.0 91.3
21 - 30	30 85.0 101.3
31 - 50	50 105.0 121.3

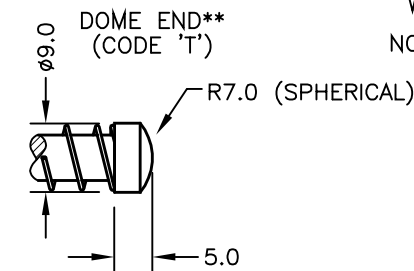

ELECTRICAL OPTIONS/ SPECIFICATIONS

OUTPUT SUPPLY
0.5 TO 4.5V RATIO METRIC 5V
SUPPLY CURRENT 12mA TYP. 20mA MAX.

CABLE: 0.2mm², O/A SCREEN, PUR JACKET - SUPPLIED WITH 50cm OR REQUIRED LENGTH IN cm (15000cm MAX).
STANDARD 3-CORE: JACKET Ø4mm BLACK e.g. L50
OPTIONAL 5-CORE: JACKET Ø4.6mm BLUE e.g. LQ50

CABLE/CONNECTOR* CONNECTIONS;

3 CORE	5 CORE	CONNECTOR	
RED	RED	:1	+Ve
-	ORG	:1	+SENSE (5-WIRE ONLY)
BLACK	BLACK	:3	0V
-	GRY	:3	-SENSE (5-WIRE ONLY)
WHITE	WHITE	:2	OUTPUT
SCREEN	SCREEN	:4	BODY

*CONNECTORS; MAXIMUM CONDUCTOR CROSS SECTION 0.75mm²
RANGE OF DISPLACEMENT FROM 2mm TO 50mm, IN INCREMENTS OF 1mm.

BODY MATERIAL: STAINLESS STEEL.
FLANGE MATERIAL: STAINLESS STEEL (CODE 'N')

FURTHER OPTIONS:
SINGLE PAIR OF BODY CLAMPS (CODE 'P')
SPRUNG PLUNGER, TO EXTENDED POSITION (CODE 'R')
DOME END (CODE 'T') IN CONJUNCTION WITH SPRUNG PLUNGER (CODE 'R')**

PLUNGER FREE (CODE 'V')
N.b. NOT AVAILABLE WITH SPRUNG OPTIONS.

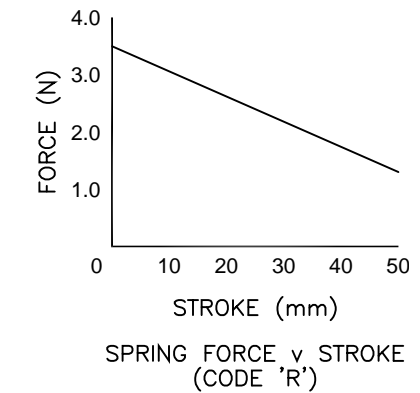

NOTE:- READ INSTALLATION SHEET X103-19 FOR FULL INSTRUCTIONS FOR USE.

ATEX / IECEx APPROVED TO
Ex II 1G
Ex ia IIC T4 Ga (Ta= -40° to +80°C)
Ui 11.4V, Ii 0.2A, Pi 0.51W

APPROVED FOR USE IN CONJUNCTION WITH A GALVANICALLY ISOLATED BARRIER.

NOTE: APPROVAL ONLY APPLIES AT NORMAL ATMOSPHERIC PRESSURE!

J	1.5-3.5N WAS 0.25-1.25N - RAN449.	PDM
K	CALIBRATION START MOVED -0.5 - RAN449	PDM
L	STROKE NOTES AMENDED.	PDM
M	STANDARD VERSION AMENDED - RAN467.	PDM
N	APPROVAL STANDARDS UPDATED - RAN465.	PDM
O	STROKE 2-10 WAS 10 - RAN1063	PDM
P	5-CORE OPTION ADDED ~ RAN1102	PDM

THE PLUNGER RETRACTS 5mm FROM START OF CALIBRATED TRAVEL (2mm FOR SPRUNG VERSIONS) AND EXTENDS 9.5mm* BEYOND END OF MECHANICAL TRAVEL. *DOES NOT INCLUDE DIFFERENCE BETWEEN CALIBRATED AND MECHANICAL TRAVEL, DIMENSIONS ARE NOMINAL. 'V' CODED PLUNGER WILL DEPART SENSOR BODY.

DRAWINGS NOT TO BE CHANGED WITHOUT REFERENCE TO THE CHANGE PROCEDURE. CHANGES TO PARTS USED IN INTRINSICALLY SAFE PRODUCT MUST BE APPROVED BY THE AUTHORISED PERSON
THIS IS AN UNCONTROLLED PRINT AND WILL NOT BE UPDATED.

Herbertek www.herbertek.se
info@herbertek.se
+46-18 590510

POSITEK
P
LIMITED

J	21/10/13		CHECKED BY	X	±0.4
K	23/10/13		PDM	X.X	±0.2
L	21/11/13			X.XX	±0.1
M	10/12/13				DIMS mm
N	10/03/14	DESCRIPTION			
O	10/11/15	X103 INTRINSICALLY SAFE			
P	10/04/17	SHORT STROKE LINEAR POSITION SENSOR			
SCALE	10mm	DRAWING NUMBER	X103-11	REV	P
					SHEET 1 OF 1