

Magnetic Incremental Encoder

- 40 mm case diameter
- Magnetic incremental encoder
- 2 - 4 - 8 - 16 - 25 - 32 - 40 - 50 - 64 - 80 - 100 - 125, 128 - 160 - 200 - 250 - 256 - 400 - 500 - 512 ppr.
- IP 54 protection



Technical Specifications

Type of Measurement	Magnetic incremental contactless
Resolution	2 ... 512 ppr.
Output Channels	A,B,Z or A,Ā, B,Ā, Z,Z̄
Output Type	Push-Pull, TTL Linedriver or HTL Linedriver
Supply Voltage	8-24 VDC (Standard) or 5 VDC (Optional)
Power Consumption (without load)	< 40 mA (24 VDC)
Electrical Connections	2.5m (Standard) 5 Wire + Shield for Pushpull 2.5m (Standard) 8 Wire + Shield for Linedriver
Max. Permissible Shaft Loading Radial	100 N
Axial	60 N
Max. Speed	3500 rpm
Shaft Diameter	Ø4 - 6 - 8 mm
Shaft Material	Stainless Steel
Case Diameter	Ø40 mm
Case Material	Aluminium / Steel
IP Degree	IP 54
Operating Temperature	-20°C ... +80°C
Storage Temperature	-30°C ... +90°C

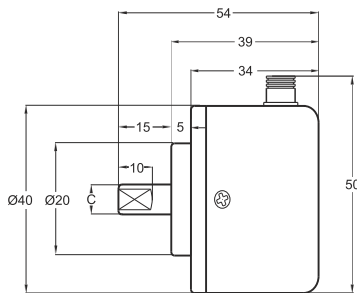

Shaft Type / Radial

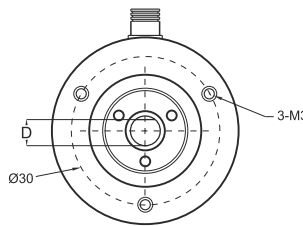

Push-Pull / TTL Linedriver Cable Output

- +V : Brown
- 0V : White
- GND : Shield
- Ch A : Yellow
- Ch B : Green
- Ch Z : Gray
- Ch A inv. : Blue
- Ch B inv. : Red
- Ch Z inv. : Pink

HTL Linedriver Cable Output

- +V : Brown
- 0V : White
- GND : Shield
- Ch A : Yellow
- Ch B : Green
- Ch Z : Gray
- Ch A inv. : Blue
- Ch B inv. : Red
- Ch Z inv. : Pink

PRI 40	R (shaft)	
	C	D
	Ø4mm	3.60mm
	Ø6mm	5.50mm
	Ø8mm	7.30mm

Model	Case Diameter	Case Type	Shaft Diameter	Output	Resolution	Output Channels	Supply Voltage	Connector / Cable	Cable Output
(example) MRI	40	A	R6	HLD	500	Z	V2	2M5	R
MRI	40mm	A : Clamping flange AW : Water proof	R4 : 4mm R6 : 6mm R8 : 8mm	LTP : Push-Pull TTL : TTL Linedriver HLD : High Linedriver	2 ... 512 ppr.	Z : A, B, Z B : A, B	V1 : 5V DC V2 : 8-24V DC	2M5 : 2.5 meter cable 5M : 5 meter cable 8M : 8 meter cable 10M : 10 meter cable C12 : 12 pin connector	R : Radial A : Axial